

## Mounting instructions

Railing system

MHTM™ FlowMotion®

**mGuide**

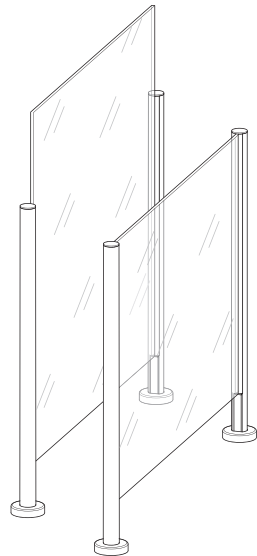
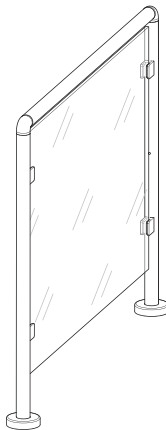
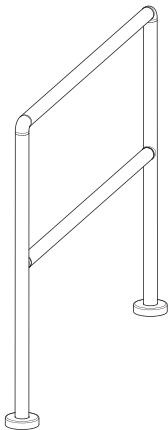

Mag10031

- de Geländersystem
- en Railing system
- fr Système de garde-corps
- it Sistema di ringhiere

# 1 Overview

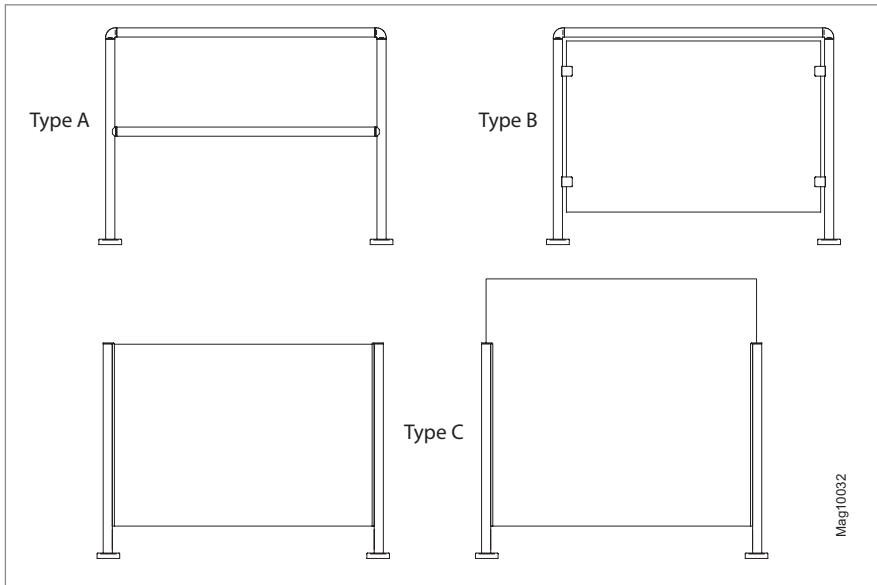

All dimensions in mm

**Type A**

The technical drawing shows the dimensions for Type A:
 

- L ±5:** Total length of the table.
- H ±5:** Total height of the table.
- KH ±5:** Height from the floor to the top rail.

	H	L	KH
<b>GBK100</b>	870	1295	480
<b>GBK101</b>	1000	1295	500

Mag10033

Type B

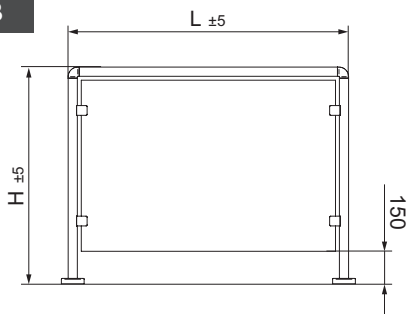

	H	L
<b>GBF100</b>	870	1295
<b>GBF101</b>	1000	1295

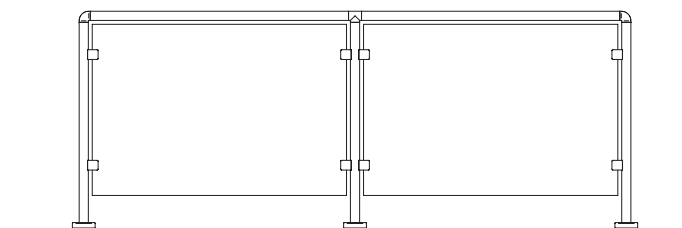

Mag10034

All dimensions in mm

Type C

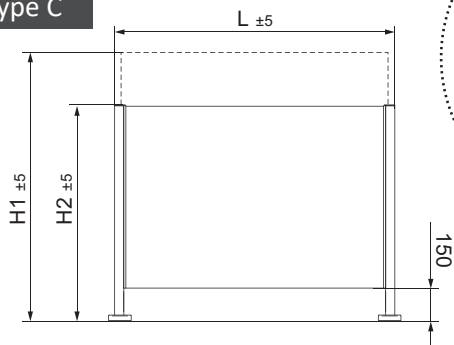

<https://www.magnetic-access.com/de-DE/downloads/berechnungstools.html>



H1	H2	L
max. 1800	1000	max. 1300

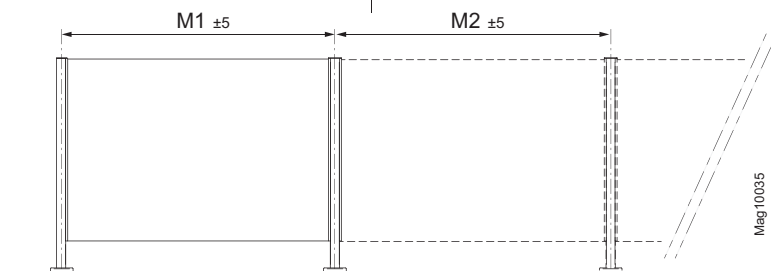

Mag10035

## 2 Assembly Type A

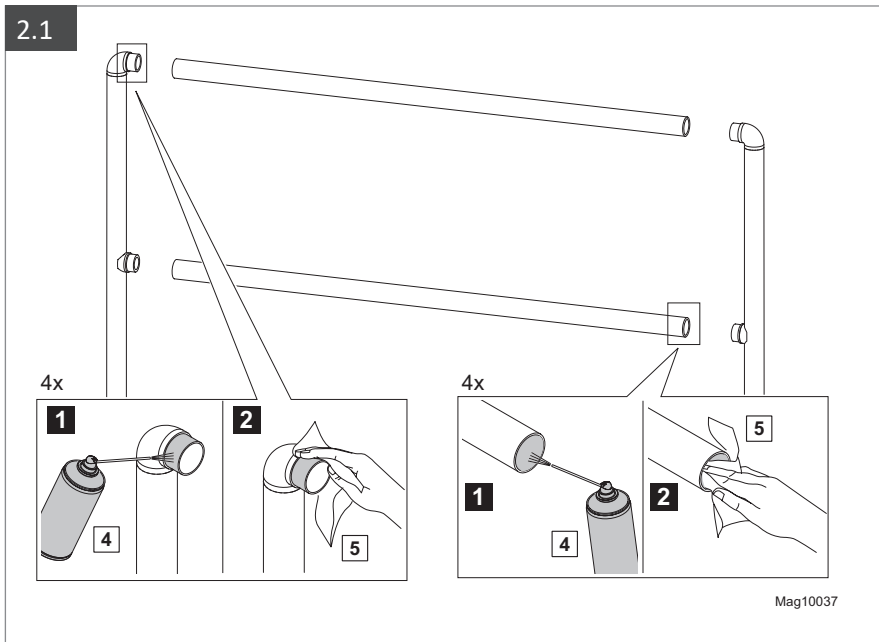
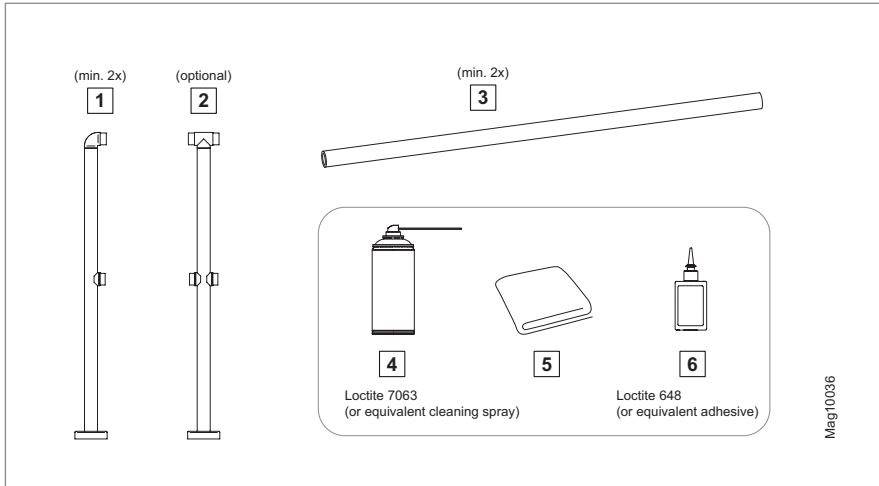

2.2

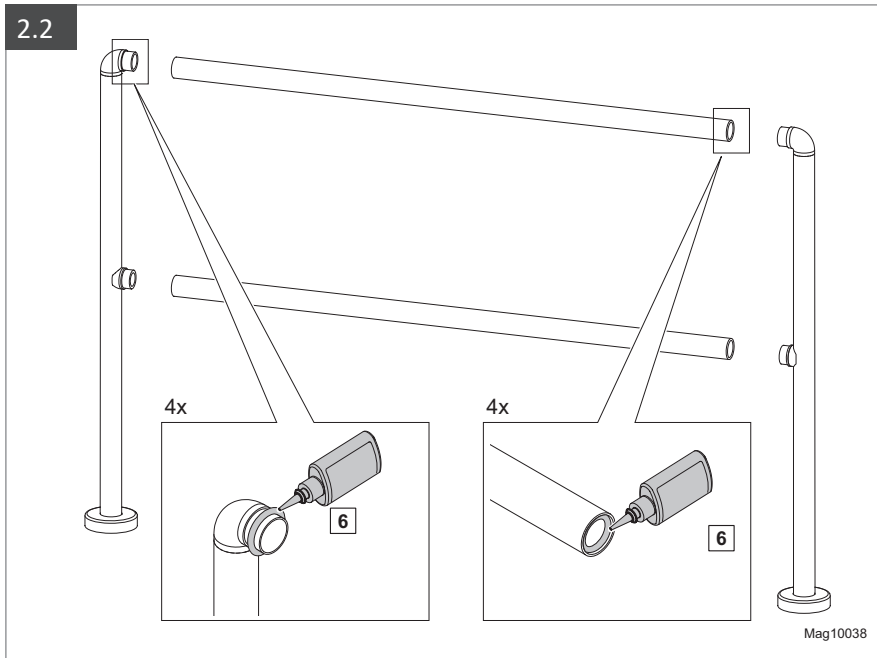

2.3

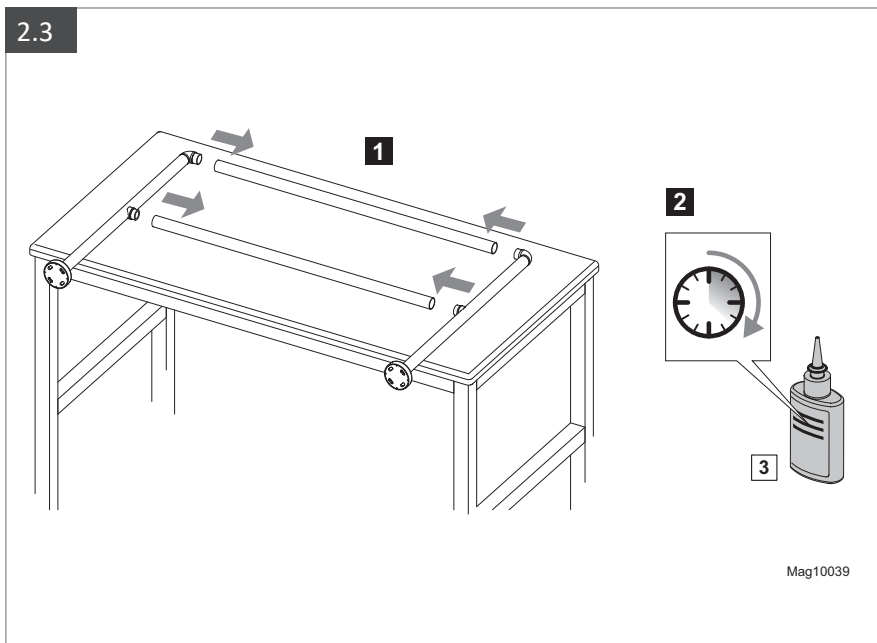

### 3 Assembly Type B

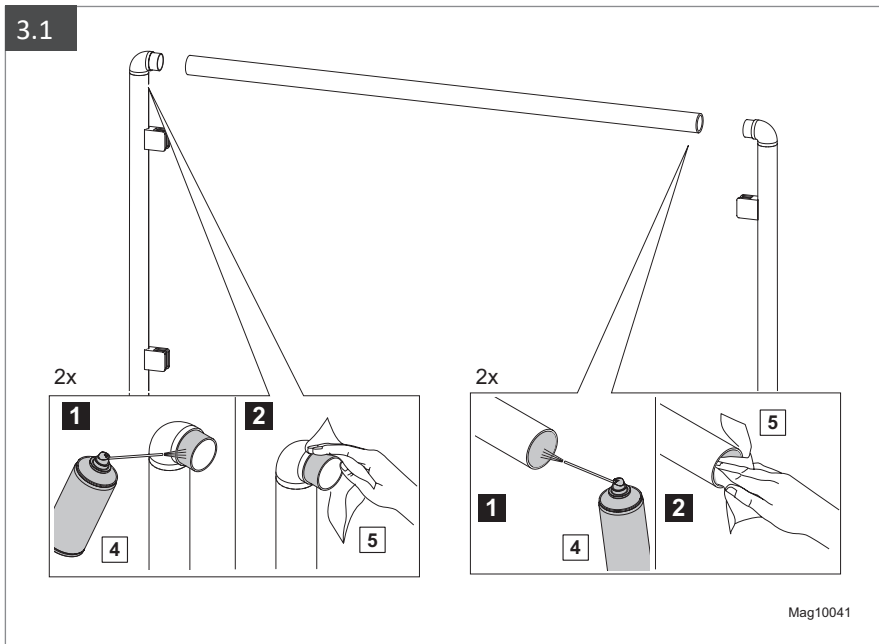
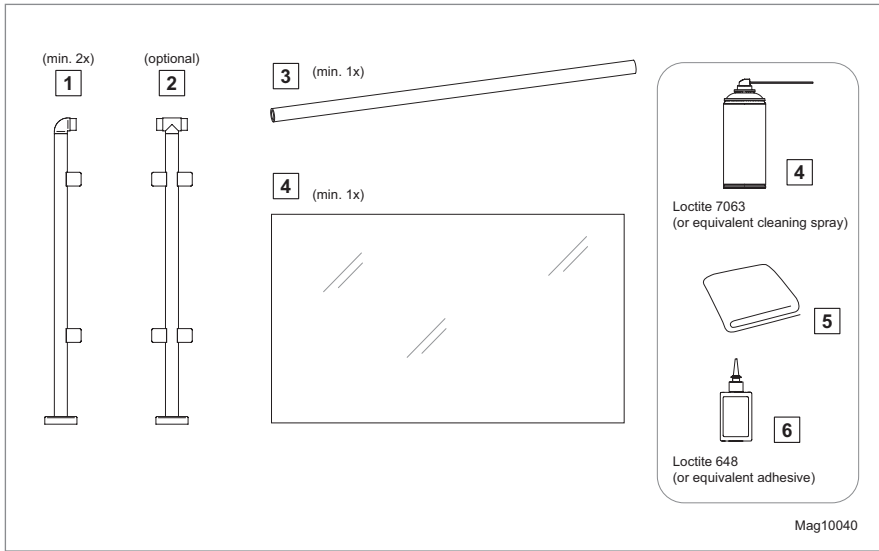

3.2

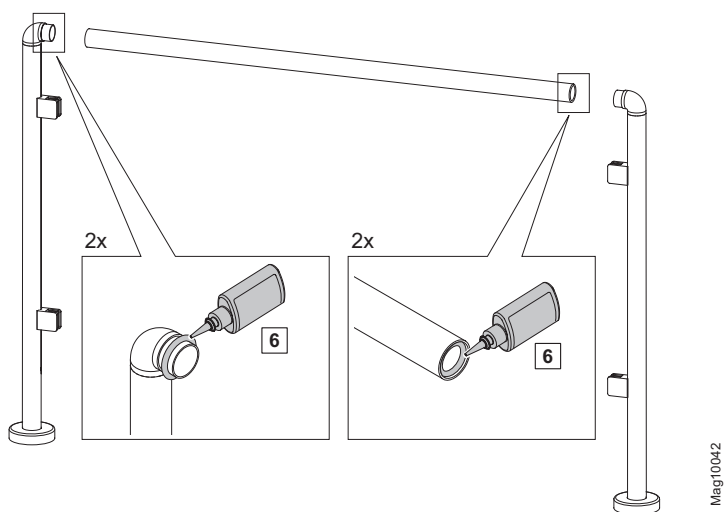

3.3

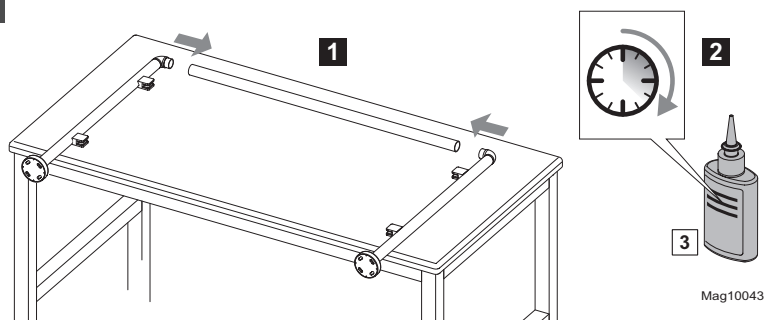

3.4

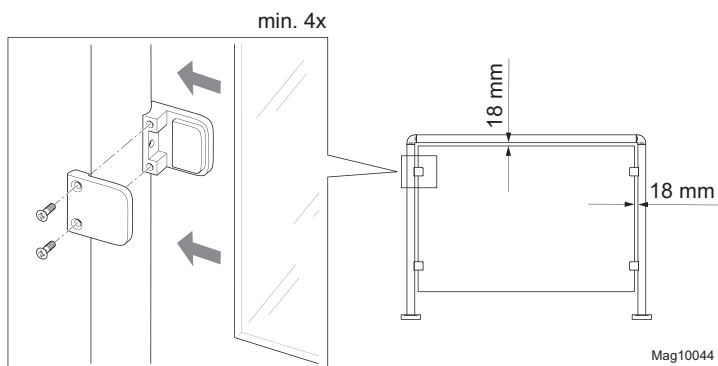



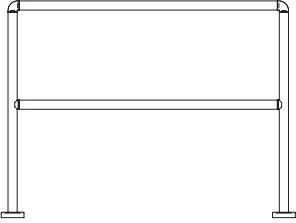

# 4 Installation Type A, B

**1** 



**2**   
UPAT UPM44 CX150

(min. 2x)

(4x) <b>3</b>  A 8	(4x) <b>4</b>  A 8	(4x) <b>5</b>  M8x30	(4x) <b>6</b>  M8
--	--	--	---

Mag10045

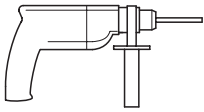
**Tools**

 $\varnothing$ 14 mm	 2 x 13 mm (M8)
--	--

**4.1**

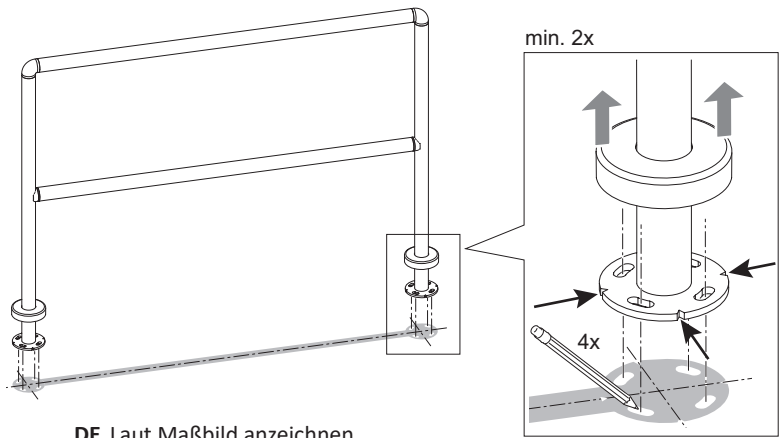

min. 2x

4x

**DE** Laut Maßbild anzeichnen  
**EN** Mark according to dimension drawing  
**FR** Marquer conformément au dessin coté  
**IT** Traccia con disegno quotato

Mag10046



4.2 min. 8x

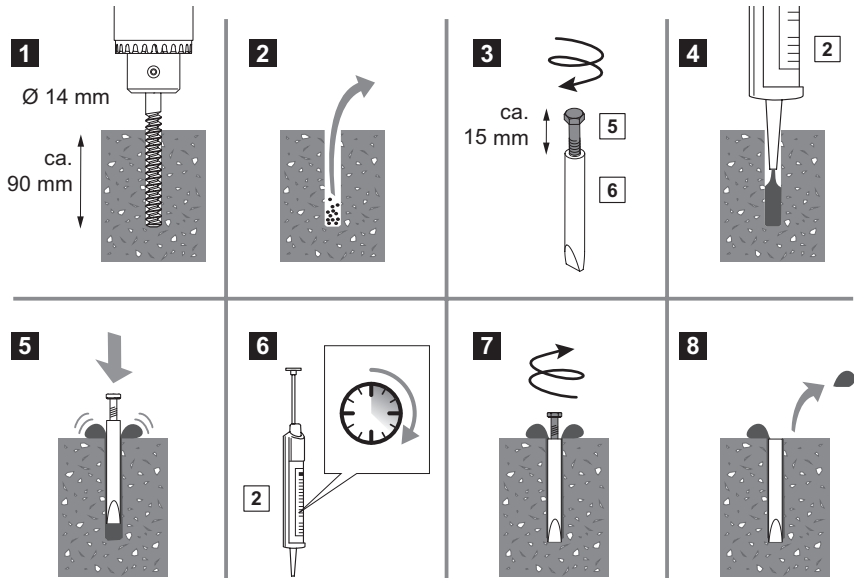

Mag10047

4.3

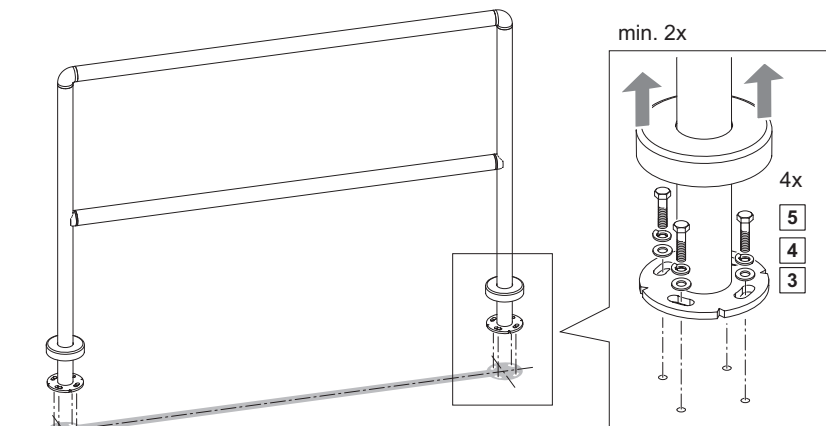

Mag10048

### 5 Installation Type C

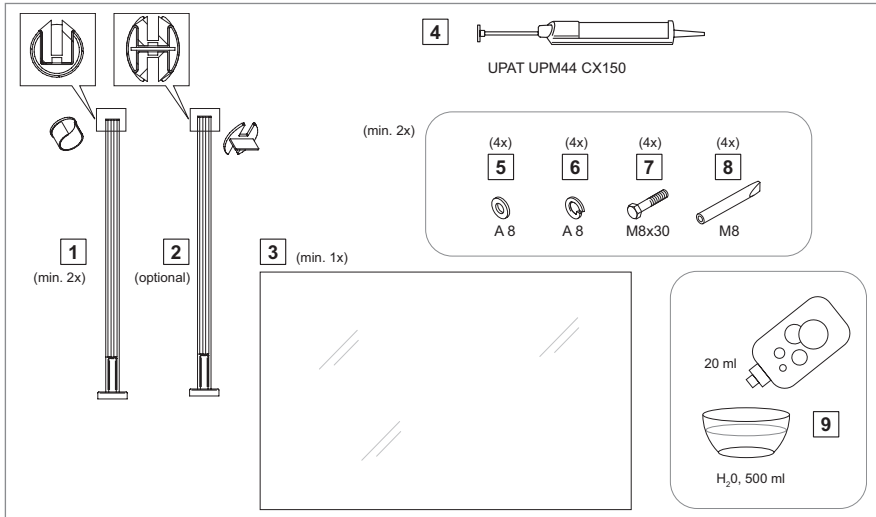

4 UPAT UPM44 CX150

(min. 2x)

(4x) 5 A 8

(4x) 6 A 8

(4x) 7 M8x30

(4x) 8 M8

1 (min. 2x)

2 (optional)



3 (min. 1x)

9

20 ml

H<sub>2</sub>O, 500 ml

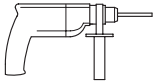
**Tools**

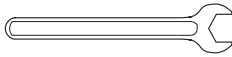
	Ø 14 mm	
	2 x 13 mm (M8)	

**5.1**

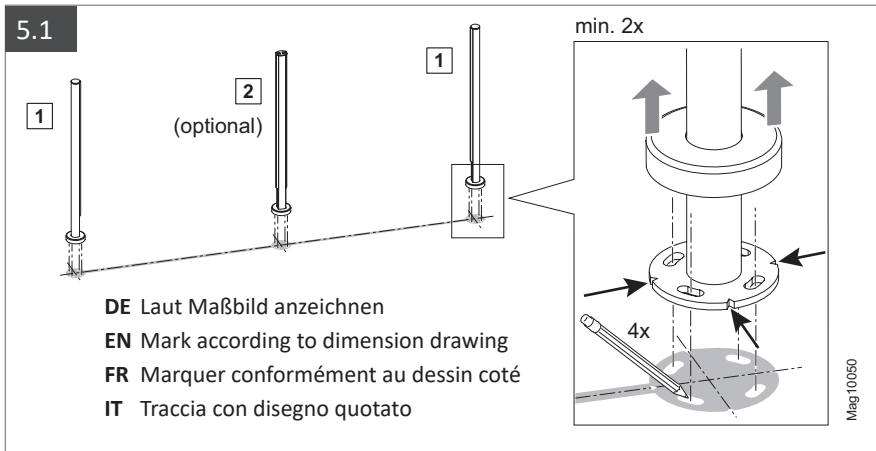

1 (optional)

1

min. 2x

4x

DE Laut Maßbild anzeichnen  
EN Mark according to dimension drawing  
FR Marquer conformément au dessin coté  
IT Traccia con disegno quotato

Mag 10050

5.2 = 4.2



---

**MAGNETIC AUTOCONTROL GMBH**

Grienmatt 20  
79650 Schopfheim  
Deutschland

Sales partner

Telefon +49 7622 695 5  
Fax +49 7622 695 802  
info@magnetic-germany.com  
www.magnetic-access.com



F10044547

Doc.ID: 5837,0014  
Version 02