

REBAR PLACEMENT PLAN

SCALE 1:20

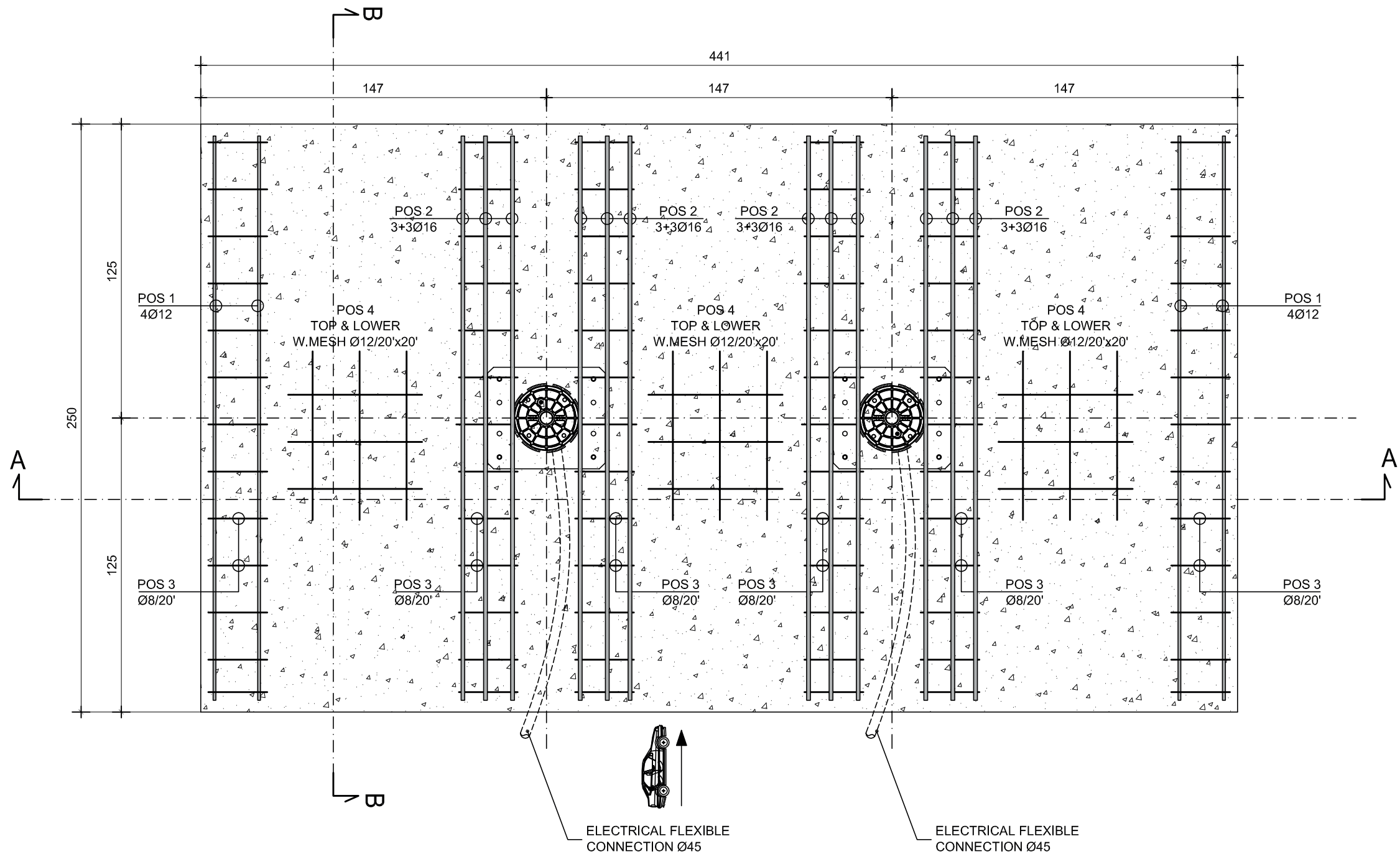

SECTION A-A

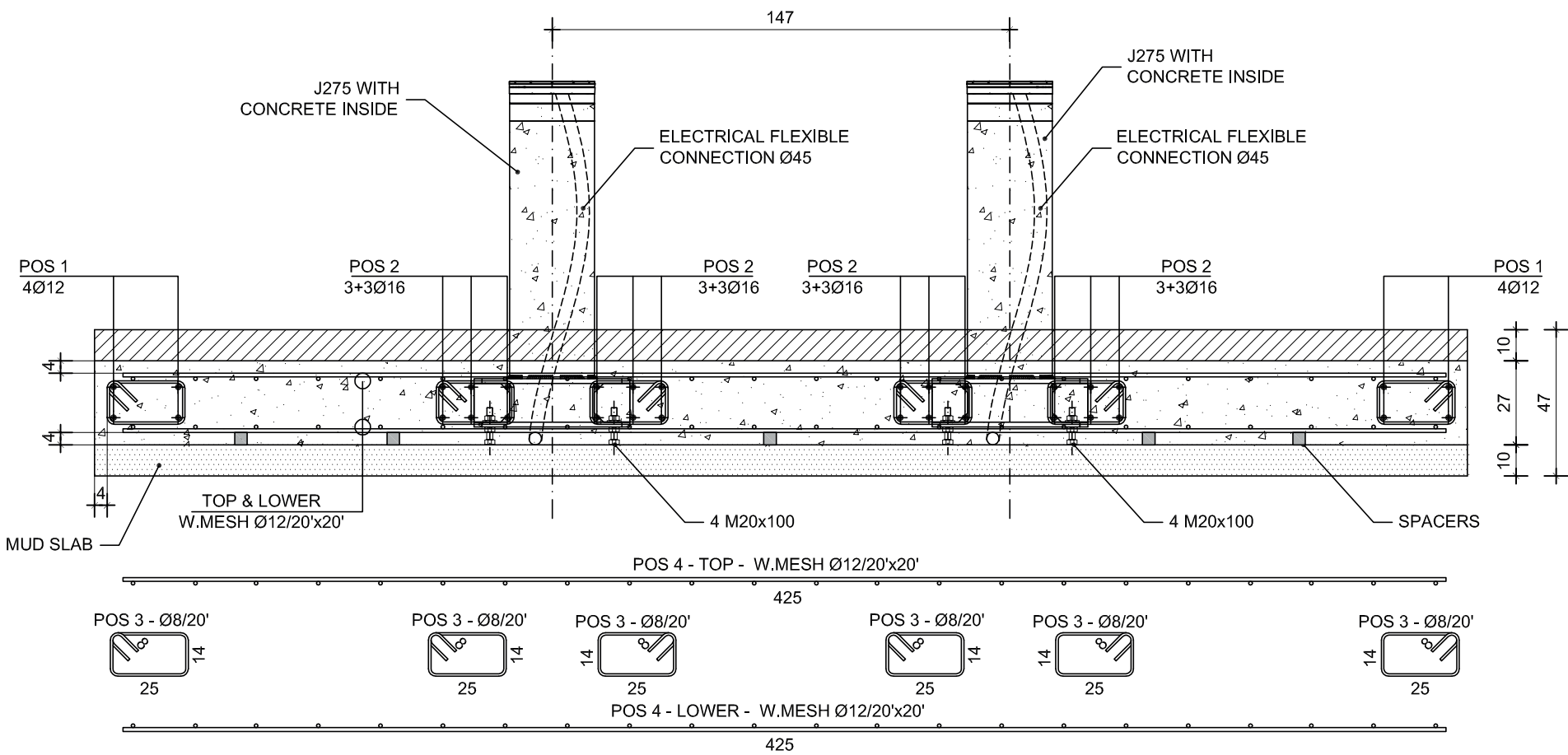

SECTION B-B

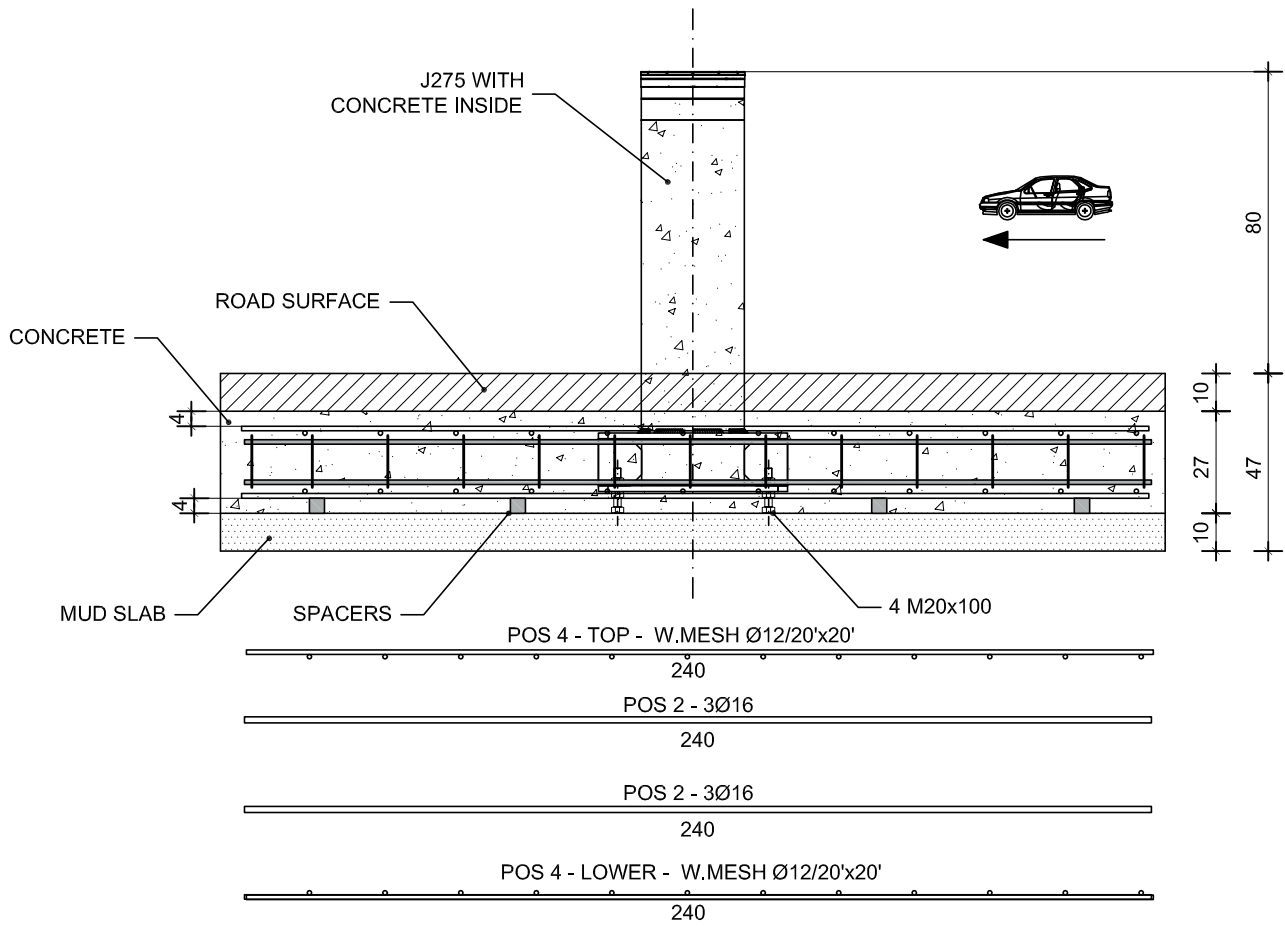

MATERIALS + SPECIFICATION

CONCRETE

	Resistance class	Type of cement	water/cement ratio (weight)	Consistance slump [mm]	Exposure class (EN206-1)	max. aggregate diameter	min. rebar cover (EC2)	additives
MODERATE EXPOSURE	C25/30	Portland 325/425	0.60	S4-160/210	XC2	20-25 mm	4.0 cm	thinner
SEVERE EXPOSURE	C30/37	Portland 325/425	0.55	S4-160/210	XD1	20-25 mm	4.0 cm	thinner
MUD SLAB CONCRETE	C12/15	Portland 325			X0	20-25 mm		

MATURATION RULES (UNI EN 13670-1:02)

Formwork removal time 48 hours
Max resistance 28 days

REBAR:

IRON B450C or N20

CONCRETE COVERS MUST BE GUARATEED BY SUITABLE MESH SPACERS

ALL DIMENSIONS MUST BE CHECKED ON SITE BEFORE TO BEGINNING WORK

REBAR SCHEDULE

pos.	n°	φ	L (cm)	W (kg)
1	8	12	240	17,05
2	24	16	240	90,91
3	78	8	95	29,24
total weight of rebar				137,20

WELDED MESH (φ 12 20x20)

pos.	n°	φ	surface	W (kg)
4	2	12	20,64	189,48

VOLUME OF CONCRETE

for foundation and bollard	mc	3,08
for mud slab	mc	1,11

VOLUME OF DIGGING

	mc	5,19
--	----	------

WEIGHT OF BOLLARD

	Kg	100,00
--	----	--------

FAAC

Via Calari 10, Zola Predosa, Bologna, Italy
Tel: 051-6172411 Fax: 051-758518

Description
J275 2K F - FOUNDATION

Code
532216

Revision
A